

South Satellite Passenger Growth and Proposed Delta Air Lines Lounge Expansion

Commission Briefing for Seattle-Tacoma International Airport



February 2, 2010

South Satellite and International Arrivals Facility



1970s



2009

South Satellite Passenger Growth and Delta Air Lines Lounge Expansion

Commission Briefing 2/2/2010

Facility Has Changed Little Despite Significant Growth



1970s



2009



South Satellite Passenger Growth and Delta Air Lines Lounge Expansion

Commission Briefing 2/2/2010

Not Much Change After All This Time

1970s



2009



South Satellite Customs and Immigration Peak Arrivals Means Many More Passengers



South Satellite Passenger Growth and Delta Air Lines Lounge Expansion

Commission Briefing 2/2/2010

Seattle's Nonstop International Services

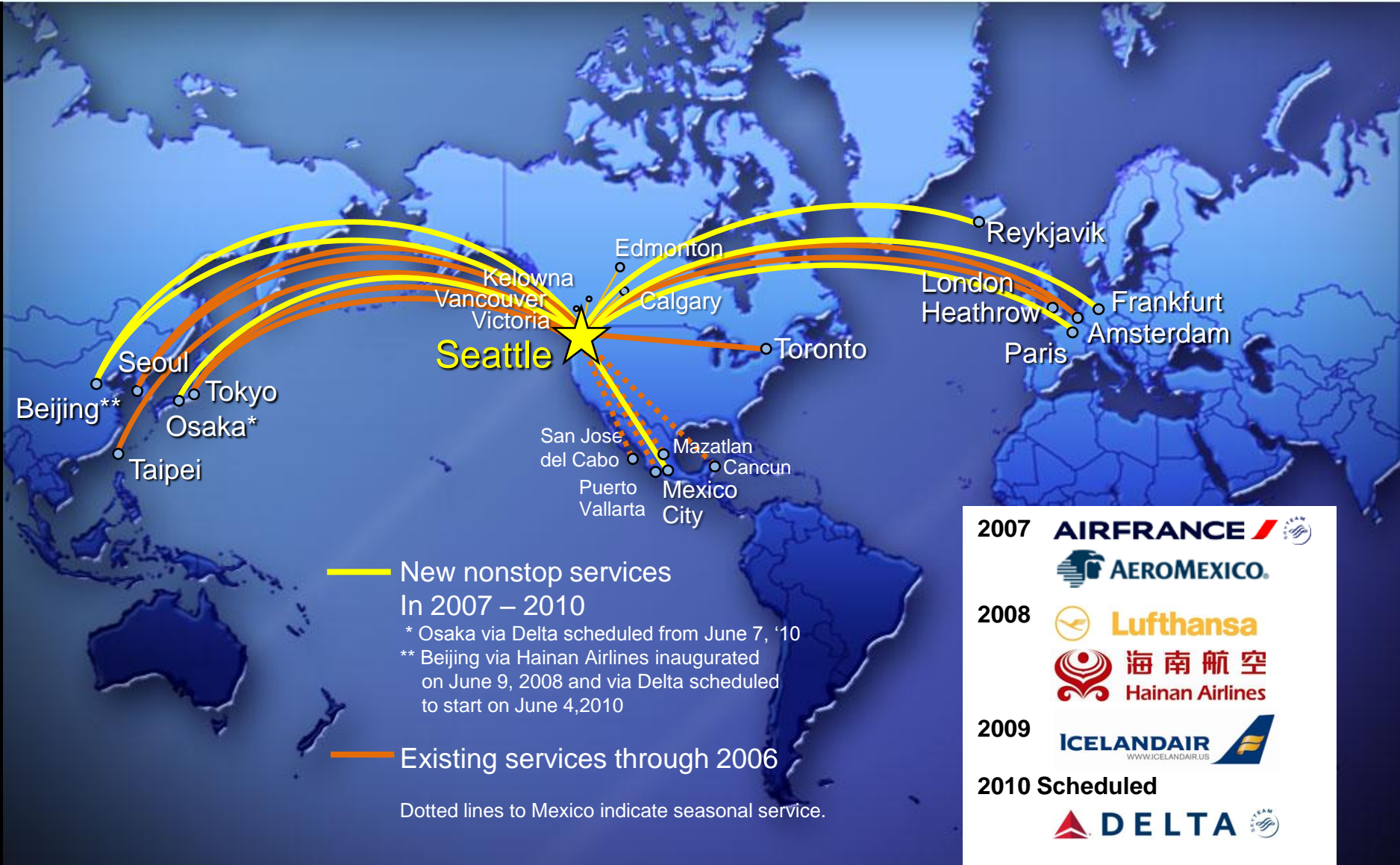

Seattle's International Traffic Growth Update

International Enplanement Comparison at West Coast Airports Latest 12 months (Nov 2008 – Oct 2009) vs. 2006

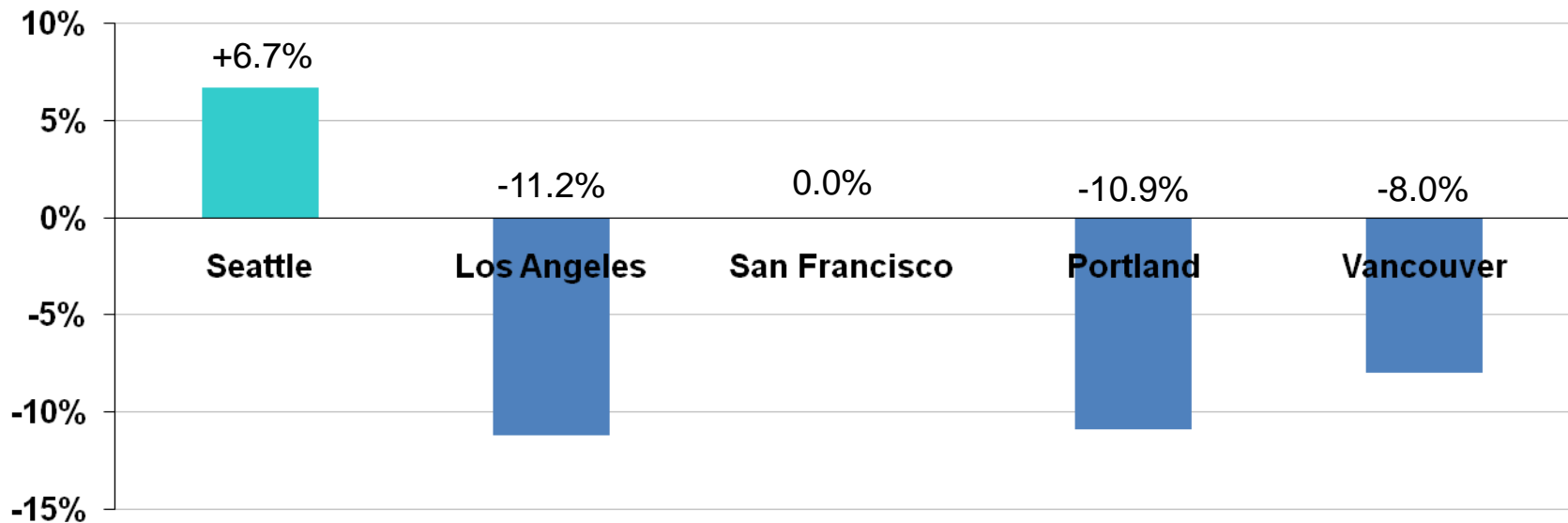

International Enplanements	Seattle	Los Angeles	San Francisco	Portland	Vancouver
2006	2,478,825	16,911,092	8,358,515	521,997	8,212,981
Nov '08- Oct '09	2,645,044	15,011,104	8,355,272	465,198	7,554,749

Source: Airport websites

South Satellite Passenger Growth and Delta Air Lines Lounge Expansion

Commission Briefing 2/2/2010

Delta Sky Club South Satellite Location



South Satellite Passenger Growth and Delta Air Lines Lounge Expansion

Commission Briefing 2/2/2010

Delta Sky Club Footprint

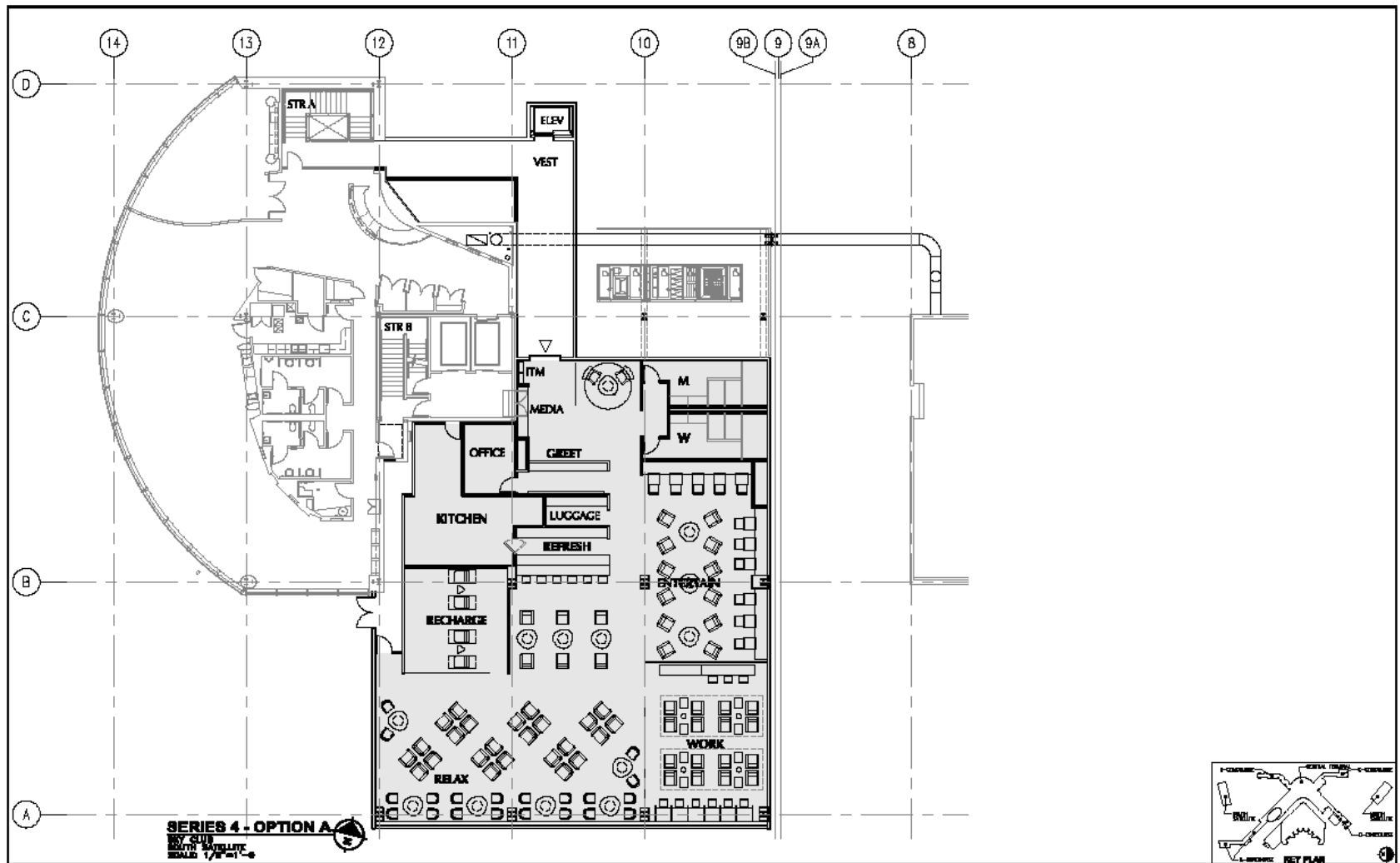

South Satellite Passenger Growth and Delta Air Lines Lounge Expansion

Commission Briefing 2/2/2010

Delta Sky Club Overview

- **Delta will be designing and constructing the rooftop airline lounge expansion as a tenant project**
- **Adds 6,500 sf of new leasable space to South Satellite (increasing Delta's club by 2,500 sf and \$550K in annual rent)**
- **Construction is slated to begin April 2010, with a tenant desired construction completion date in December 2011**
- **Total project cost is expected to be between \$6M - \$8M, including removal of regulated materials. Port's tenant reimbursement responsibility on projects of this scale have been historically between 60%-70%, exclusive of regulated material removal**
- **Removal of Regulated Materials for this project is estimated to be between \$1M - \$1.8M. Because of Delta's schedule constraints, this element will be covered with Commission on February 9, 2010**